

### Specifications

Current Rating: 7A AC,DC  
 Contact Resistance: 20mΩ Max  
 Insulation Resistance: 1000MΩ Min  
 Withstanding Voltage: 1000V AC/minute  
 Temperature Range: -40°C ~ +105°C

### Material

Insulator: LCP, UL94V-0  
 Contact: Copper Alloy

### ORDER INFORMATION

P	D	50	25	X	4	A/L/B - 1	XX
Stack Straight Type	Height=2.5mm	RoHS + LCP	Customer Design Dimension	No. of Contacts Per Row (01~20)			
Pitch 5.08mm	G0:Gold Flash G1:Gold 3u" G2:Gold 5u" G3:Gold 10u" G4:Gold 15u" G5:Gold 30u"	S0:Selective Flash S1:Selective 3u" S2:Selective 5u" S3:Selective 10u" S4:Selective 15u" S5:Selective 30u"		Single Row			

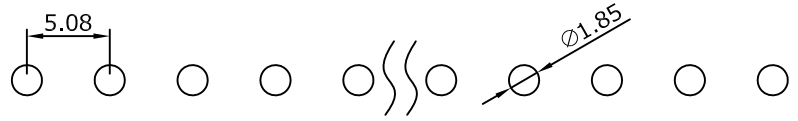
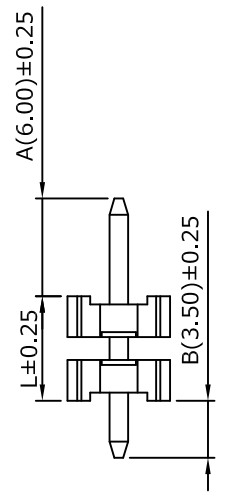
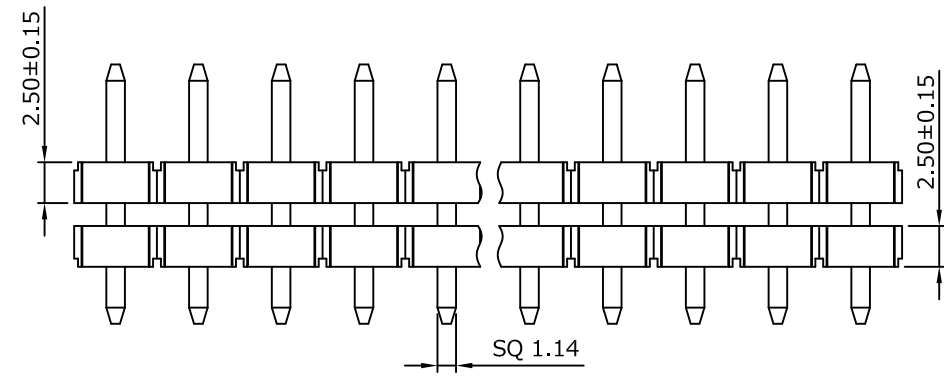
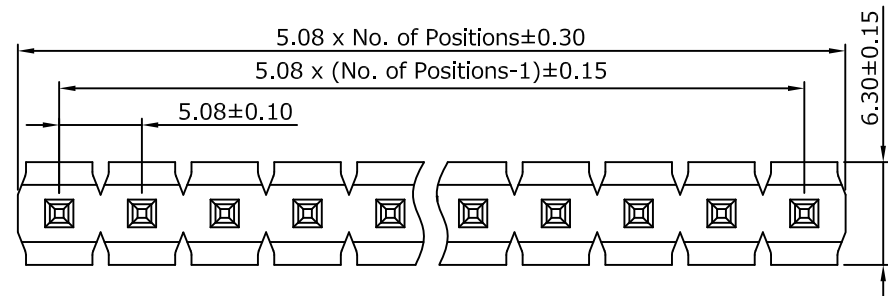

Recommended PCB Layout  
 (PCB TOLERANCE ±0.05)

			<p><b>Morecrafts</b>                  Tel: +886-2-2966-1326                  Fax: +886-2-2966-1352</p>	品號 PART NO.	PD5025X4A/L/B-1XX	日期 DATA	2009/02/13			
				圖號 DRAWING NO.	PD5025X4A/L/B-1XX	繪圖 DRAWN	Sayid			
				客戶品號 CUSTOMER P/N		核對 APPROVED	Max			
REV.	DESCRIPTION	DATA	TITLE: Pin Header 5.08mm Plastic Height 2.5mm	REV. A	公差 TOLERANCE	.X ±0.25 .XX ±0.20	比例 SCALE	FREE	單位 UNIT	mm